

HOW TO INSTALL REPLACEMENT HANDLES

HAMMER & HAND AXE HANDLES

1. Saw off old handle flush with tool head.



2. Punch out wood from tool eye.



Wood blocks



3. Drive in new handle and wood wedge. Cut off excess wood flush with tool head.



4. Drive in steel wedge diagonally.

SLEDGE & AXE HANDLES

1. Saw off old handle flush with tool head.



2. Punch out wood from tool eye.



Wood blocks

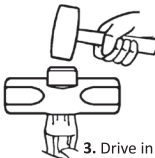

3. Drive in new handle and wood wedge. Cut off excess wood flush with tool head.



4. Drive in steel wedge diagonally.

MATTOCK & EYE HOE HANDLES

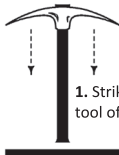

1. Strike down to take tool off old handle



2. Slip tool on new handle.

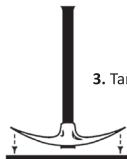

3. Tamp down.

4. To keep tool from sliding down, insert wood screw at base of tool on wide side of handle.

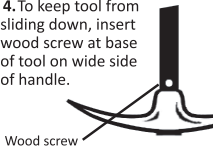

Wood screw

FOR YOUR SAFETY AND CONVENIENCE:

Wear safety goggles to protect your eyes.

Bring old tool to store to measure for replacement handle.



LINK HANDLES

SEYMOUR MIDWEST LLC • WWW.SEYMOURMIDWEST.COM

HOW TO INSTALL REPLACEMENT HANDLES

FORKS WITH D-GRIP HANDLES

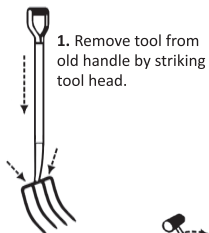

1. Remove tool from old handle by striking tool head.

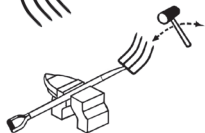

2. Put protective wrap on new handle and place in vise. Drive tool head onto handle



3. Secure handle to head with a screw or nail.

FOR YOUR SAFETY AND CONVENIENCE:

Wear safety goggles to protect your eyes. Bring old tool to store to measure for replacement handle.

HOE, RAKE, & FORK HANDLES

1. Remove rivet.
2. Lock handle in vise and pull tool head from old handle.
3. Check handle fit and resize handle hole if needed. Put wood glue in handle hole.

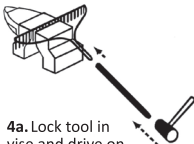

4a. Lock tool in vise and drive on new handle.

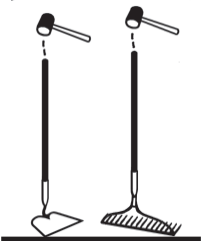

4b. For socket pattern tools, follow steps 1 through 3. Then place head on solid surface and drive on handle.

SHOVEL & SPADE HANDLES

1. Remove rivet.
2. Rotate shovel on anvil of vise while hammering on shank of tool to loosen handle.
3. Lock old handle in vise and drive tool off.
4. Check tool for fit and lubricate with oil.

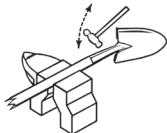

3. Lock old handle in vise and drive tool off.

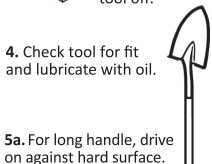

5a. For long handle, drive on against hard surface.



5b. For D-grip handle, drive on against wood surface or block.

6. Drill 3/16" hole and install rivet. Brad the rivet with round end of ball peen hammer.



LINK HANDLES

SEYMOUR MIDWEST LLC • WWW.SEYMOURMIDWEST.COM